

sezione tecnica technical section

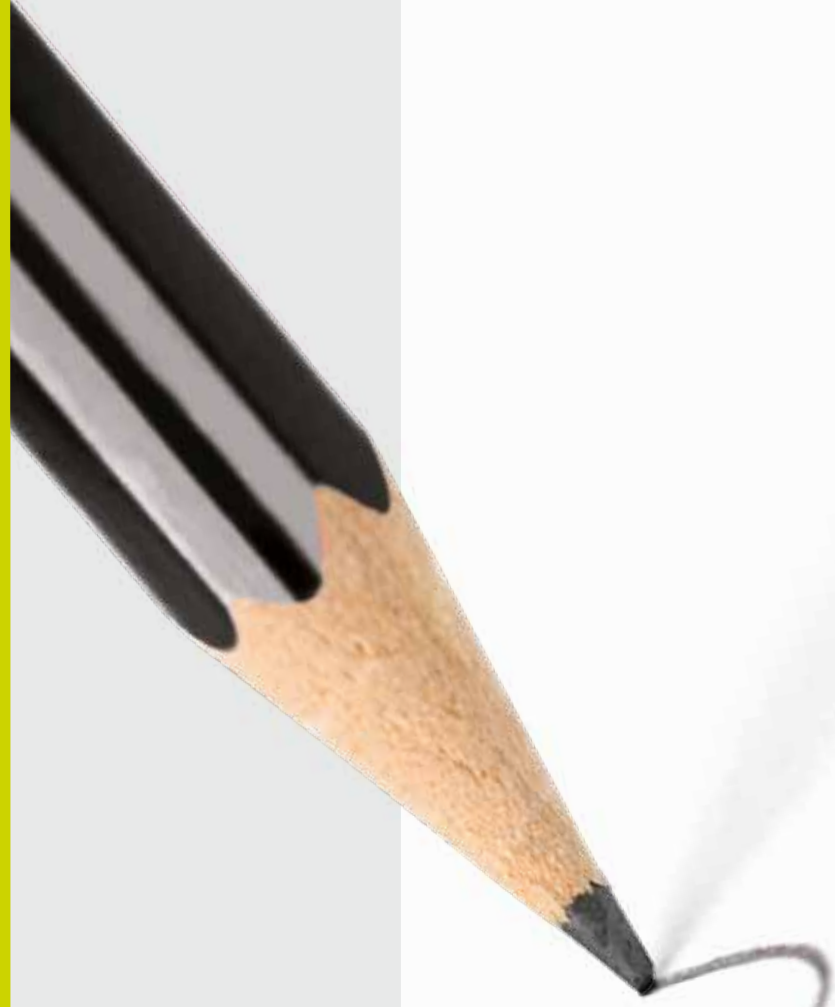

apertura a spingere - destra  
*right push - open leaf*

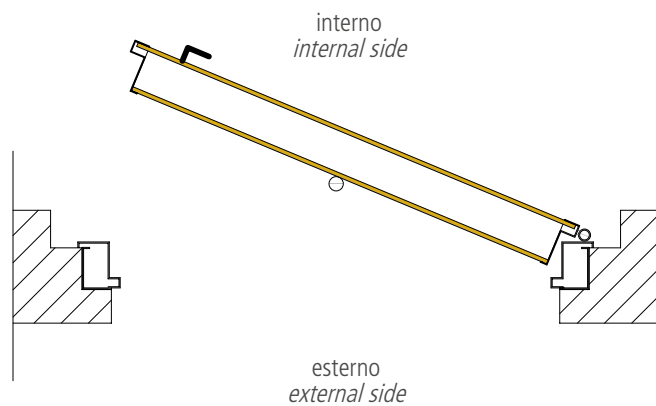

apertura a spingere - sinistra  
*left push - open leaf*

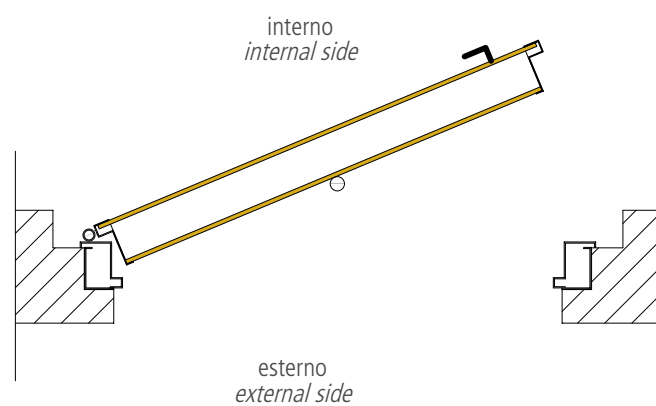

apertura a tirare - destra  
*right pull - opening leaf*

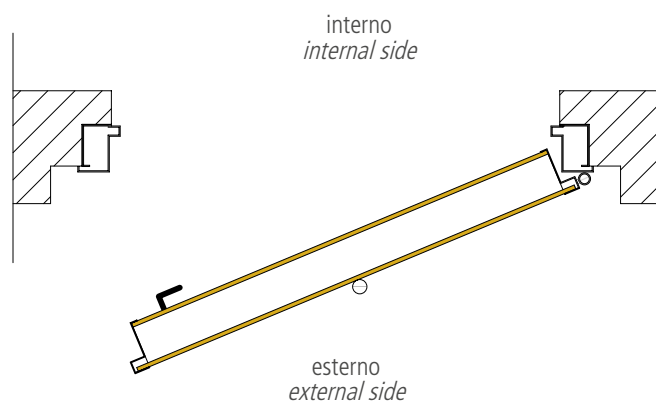

apertura a tirare - sinistra  
*left pull - opening leaf*

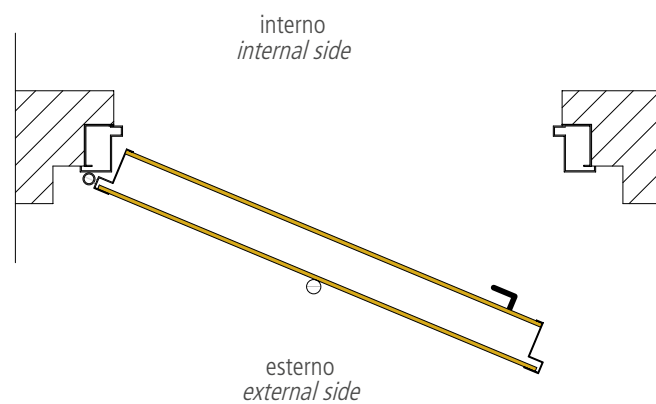

sezione orizzontale  
horizontal section

sezione verticale  
vertical section

montaggio a filo intonaco interno  
Assemblage of the sub-frame inside plaster

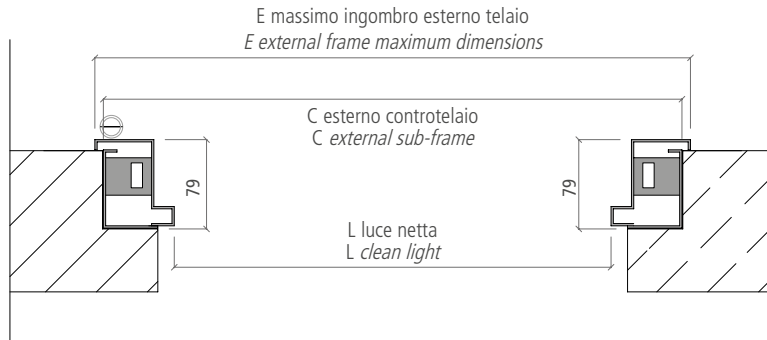

montaggio a centro muro  
assemblage in the middle of the wall

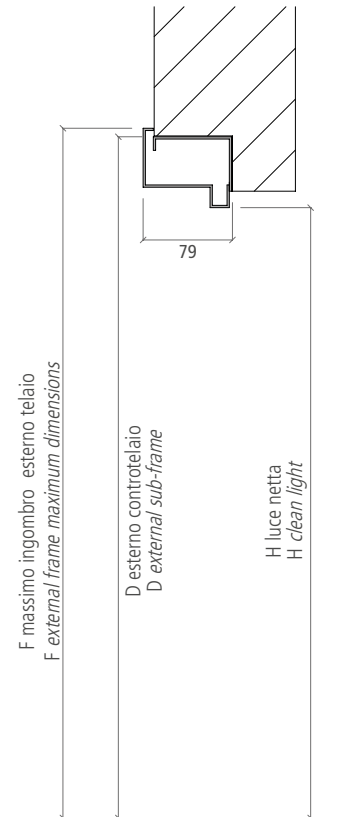
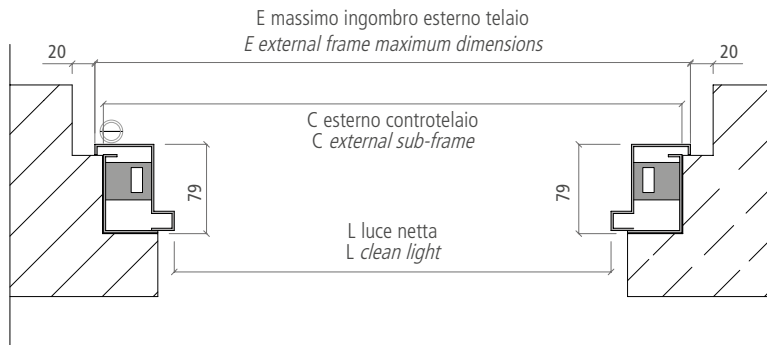

L-H= luce netta <i>clean light</i>
C-D= esterno controtelaio <i>external sub-frame</i>
E-F= massimo ingombro esterno telaio <i>external frame maximum dimensions</i>

L	H	C	D	E	F
80	210	92,5	216	94	217
85	210	97,5	216	99	217
90	210	102,5	216	104	217

L	H	C	D	E	F
70+30	210	112,5	216	114	217
75+30	210	117,5	216	119	217
80+30	210	122,5	216	124	217
85+30	210	127,5	216	129	217
90+30	210	132,5	216	134	217

consigli per il montaggio del contro telaio  
*advice for the assemblage of the sub-frame*

montaggio a filo intonaco interno  
*assemblage of the sub-frame inside plaster*

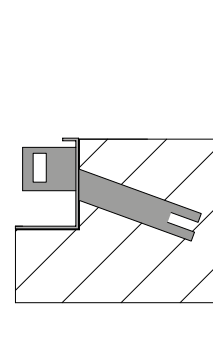
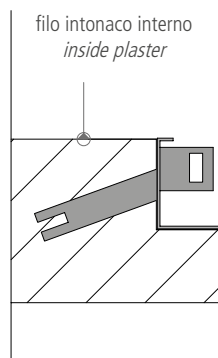

montaggio a centro muro  
*assemblage in the middle of the wall*

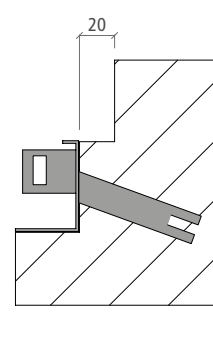
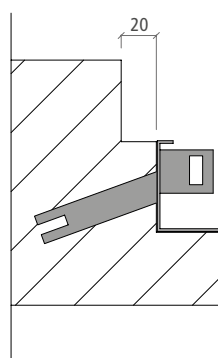

Attenzione / attention

- 1 L'intonaco (muro finito) deve stare sul filo del contro telaio  
*The plaster should be at the same level of the sub-frame*
- 2 Il contro telaio deve poggiare con i due montanti sul piano del pavimento finito  
*The sub-frame must rest with two jambs on the floor*
- 3 Controllare che il contro telaio sia perfettamente a piombo  
*You have to check that the sub-frame is perpendicularly*
- 4 Non togliere i distanziali prima che la muratura abbia fatto presa  
*Don't remove the spacers till the wall has set*

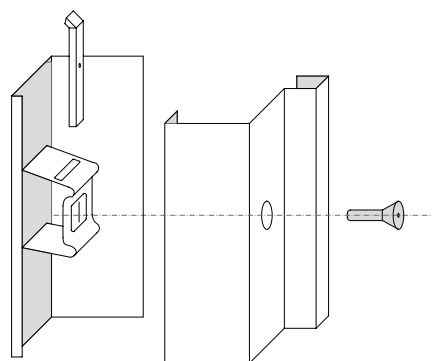

Montaggio del telaio sul contro telaio  
*assemblage of the frame on the sub-frame*

- 1 Sfilare il telaio dall'anta  
*Remove the frame from the leaf*
- 2 Togliere i distanziali dal contro telaio  
*Remove the spacers from the sub-frame*
- 3 Posizionare il telaio nel contro telaio e fissarlo con viti a testa svasata da 8 x 20  
*Place the frame on the sub-frame fixing it with screws 8x20*
- 4 Registrare l'anta in senso orizzontale e in senso verticale agendo sulle cerniere  
*Adjust the leaf horizontally and vertically acting on the hinges*

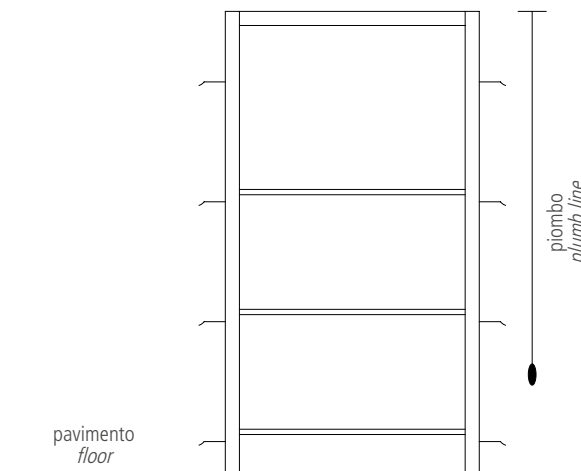

montaggio del controlaio per porta con apertura a tirare  
*assemblage of the sub-frame for pull opening door*

montaggio a filo intonaco esterno - *assemblage outside plaster*

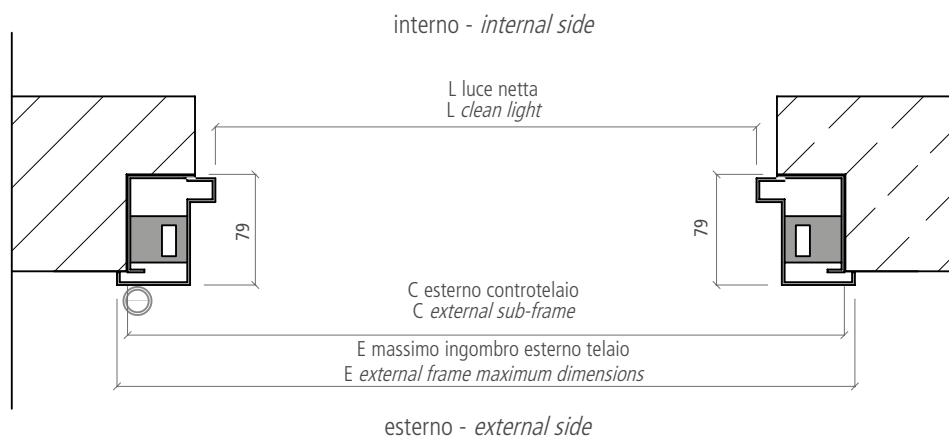

montaggio a centro muro - *assemblage in the middle of the wall*

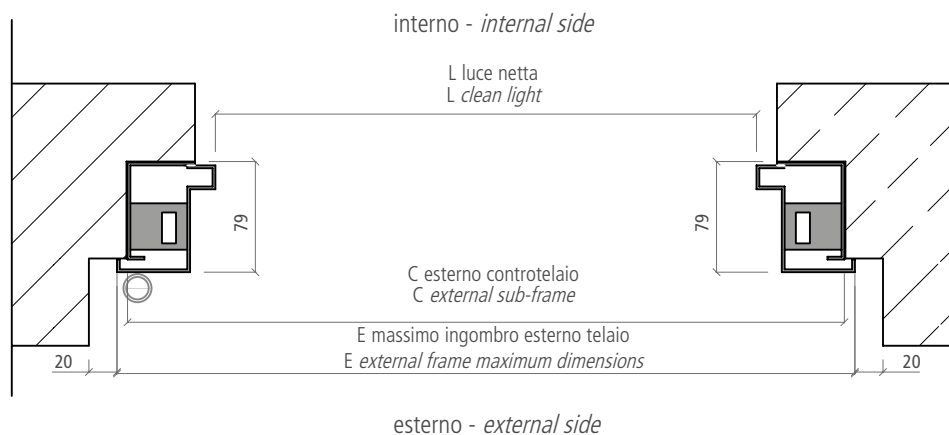

montaggio a filo intonaco interno - *assemblage inside plaster*

